



E-Star Power Development Co., Ltd. (E-STAR)
 1F., No.40, Juren Ln., Sec. 2, Sanmin Rd., Banciao Dist., New Taipei City
 22069, Taiwan (R.O.C.)
 Phone : 886-2-2957 5580 Fax : 886-2-2957 7473

120W Vehicle power adapter DC to Dc power supply < ED1010



Features

- RoHS Compliance
- Wide Input Range
- Input Voltage Protection Installation
- Over Current Protection Installation
- Over Temperature Protection Installation
- Short Circuit Protection Installation
- 100% Burn-In
- LED Indication
- MTBF: >50,000 hours

ED1010 x YY - vv

x: Output range

YY: DC Input Type:

vv: Specified output voltage, ie 24 is 24Vdc

Electrical Specifications

MODEL No.	MAX. OUTPUT POWER (W)	INPUT VOLTAGE (Vdc)	OUTPUT VOLTAGE (Vo)	LOAD		LOAD REGULATION	LINE REGULATION	RIPPLE & NOISE
				MIN. (Io)	MAX. (Io)			
ED1010A	120W	11~16V	16V	0	7A	± 5%	± 2%	300mV
ED1010B	120W	11~16V	18V	0	6.7A	± 5%	± 2%	300mV
ED1010C	120W	11~16V	19V	0	6.3A	± 5%	± 2%	300mV
ED1010D	120W	11~16V	20V	0	6.0A	± 5%	± 2%	300mV
ED1010E	120W	11~16V	24V	0	5.0A	± 5%	± 2%	300mV

NOTE:

1 : Ripple & noise is measured by using 20MHz bandwidth limited oscilloscope and terminated each output with a 0.1uF ceramic capacitor & parallel with 47uF aluminum capacitor at full load and nominal line.

2 : Max. Output Power (W) $\geq V_o \times I_o$

Electrical Specifications

INPUT

- Input Range 11 to 16 Vdc
- Input Current 12A Max.
- Inrush Current No Damage to relative components
- Efficiency 87% Min. Nominal input

OUTPUT

- Over Current Protection Auto Recovery
- Over Temperature Protection Auto Recovery

ENVIRONMENTAL

- Operating Temperature 0 to 40°C
- Storage Temperature -20 to 85°C
- Storage Humidity 5% to 95%

SAFETY

- e1

Mechanical Specification

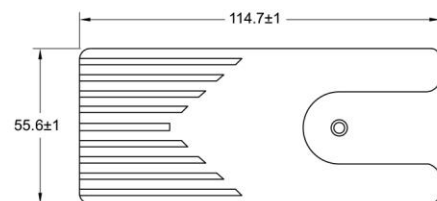

- Case Size: 114.7L x 55.6W x 35H (mm)
- DC Input: Cigarette Lighter with UL1185 dc cable.
- Weight: 300g